

Moves the Product Gently,
Safely & Efficiently



Savolyk

Valves & Pumps



Engineering the milky way

SINCE 1972



SWASTIK ENTERPRISES, (RAJAHUMNDRY)

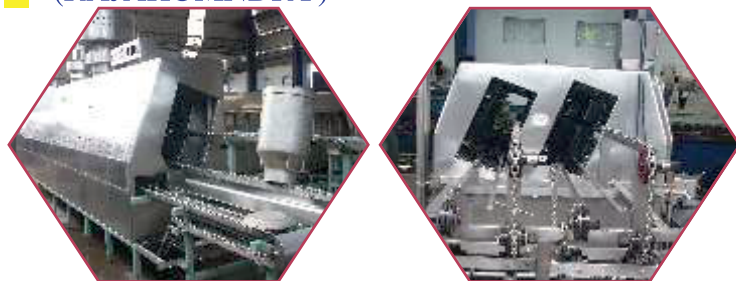

SWASTIK VALVES & PUMPS, (PUNE)

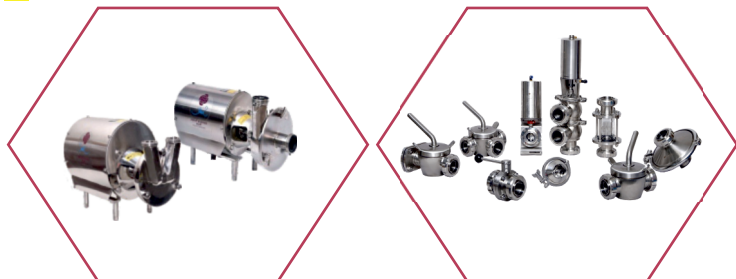

SWASTIK ASSOCIATES (PUNE)

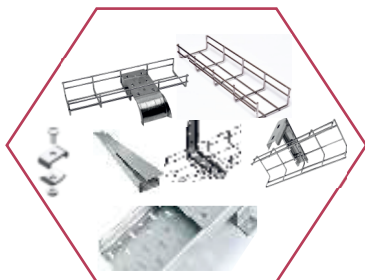

SWASTIK AGRO, (PUNE)



SWASTIK ENTERPRISES, A well established, reputed & well known Manufactures of Dairy Equipments and it's Allied Products in India, since last 35 years. Swastik is today successfully voyaging through the Dairy Equipments of the India and Overseas.. A Leading manufacturer of sophisticated equipments for the Dairy Industry, Swastik has always built the best machinery with the latest technology and has never cut corners where quality is concerned.

Swastik has over the past 3 decades, continued to be at the forefront in its field. The company has maintained an unwavering commitment to its customers by being proactive in supporting their needs and by providing quality individualized solutions according to their specific need. The company also maintains a rigorous quality assurance program along with R & D efforts in order to provide a cutting edge in the manufacture of Dairy Equipments.

Swastik Having vast experience in the field has ventured to promote an individual and independent Manufacturing Unit, especially and exclusively for manufacturing of SS Centrifugal Milk Pumps / Sanitary Valves & Fittings of Various Models / Sizes, by implementing latest developed technology and design with unique feature, ranging from 0.5 Hp to 10.0 HP to cater the needs of Dairy / Beverage / Chemical / Pharma & Food Processing Industries.

AN ISO 9001:2008 CERTIFIED COMPANY

Product

Sanitary Plug valve



APPLICATION -

The Stainless Steel plug valve is used in Dairy & Food Processing Industries & where the most stringent hygienic requirement & closing device with minimum pressure drop.

STANDARD DESIGN & FEATURES -

- The plug valve is design for quick & easy operations. The plug has a circular bore & conical shape. The Plug body & conical plug is lapped with each other. Plug valve is provided with 'O' rings ensuring that no leakage & screw cap is only tightened.
- Fully Machined components in AISI 304/316L Stainless steel excellent corrosion resistance no porosity
- The Valve is constructed to the highest specification, thus ensuring optimum level of hygiene and cleanliness by nature of its design.

TECHNICAL INFORMATION:-

- Maximum Pressure :- 10 Bar
- Maximum working Pressure:- 4 Bar
- Maximum test Pressure :- 6 Bar
- Maximum Temp. :- + 90° C,
- Minimum Temp. :- -20° C.

SPECIFICATIONS -

- Product wetted:- AISI 304 / 304 L / 316 / 316 L
- Other steel parts:- AISI 304
- Rubber Part:- EPDM, NBR, SILICON & OPTIONAL
- Plastic:- PTFE & OPTIONAL
- Finish :- SEMI BRIGHT

CONNECTIONS -

Please mention - SMS/IDF/DIN

SIZES -

- 25 MM / 38 MM/ 51 MM
- 63 MM / 76 MM/100 MM

PLUG VALVE TORQUE VALUE

SIZE	25 mm	38 mm	51 mm	63 mm	76 mm
MAX TORQUE	20.3	24.4	36.6	48.8	84

3 WAY PLUG VALVE

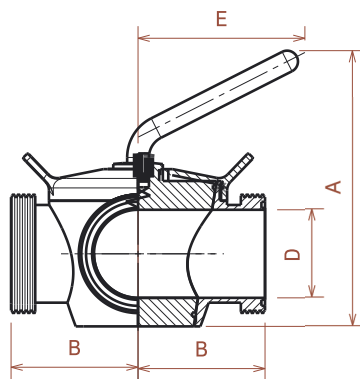
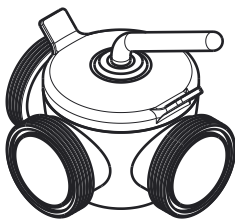

D	A	B	E
25.4	144	55	120
38.1	170	70	130
50.8	190	82	145
63.5	230	105	170
76.2	258	110	190



Product

Sanitary Manual Butterfly Valve



APPLICATION

- Stainless Steel Hygienic Butterfly Valves, which are very suitable applications for Dairy, Beverages, Chemicals, Pharma & Food Process Industries.

STANDARD DESIGN & FEATURES

- The valve consists of two valve bodies. The valve assembled by means of nut & bolts. The valve consists of flap disc, bushes & seal ring.
- The valve's disc is highly polished and crevice free which is easily cleaned.
- Ptfe stem bushing ensures the extra smooth disc rotations.
- Minimum flow resistance/pressure drop.
- SVP butterfly valves offers great durability and easy of use for wide range of service.
- Easy to install & maintain, butterfly valve close under pressure to form a leak tight seal .

BUTTERFLY VALVE TORQUE FIGURES NM

SIZE	25 mm	38 mm	51 mm	63 mm	76 mm	101 mm
MAX TORQUE	6	6	13.5	13.5	20.3	23

BUTTERFLY VALVE

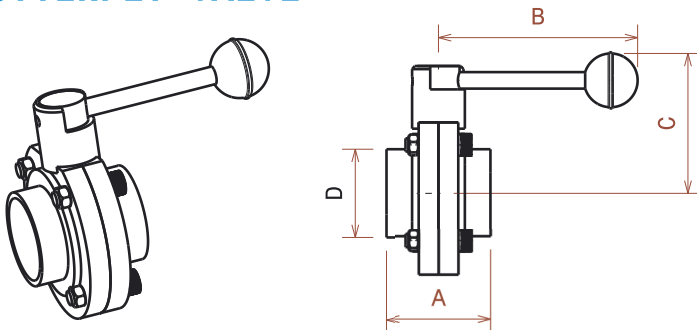

D	A	B	C
38.1	47	120	73.5
50.8	52	120	83
63.5	54	120	93
76.2	62	170	98
101.6	80	170	118

TECHNICAL INFORMATION

- Working Pressure: - 0.9 to 10 Bar.
- Maximum Product Pressure: - 10 Bar
- Minimum Product Pressure: - full vacuum
- Maximum Temp. : + 95° C,
- Minimum Temp. : -10° C.

SPECIFICATIONS

- Gasket :- Nitrile / EMPDM / SILICON
- Finish :- SEMI BRIGHT,
- Product Wetted Steel Part :- AISI 304/316 & 316L
- Other Steel Part :- AISI 304

CONNECTIONS

Please mention :- SMS/IDF/DIN

SIZES

25 MM / 38 MM/ 51 MM / 63 MM / 76 MM

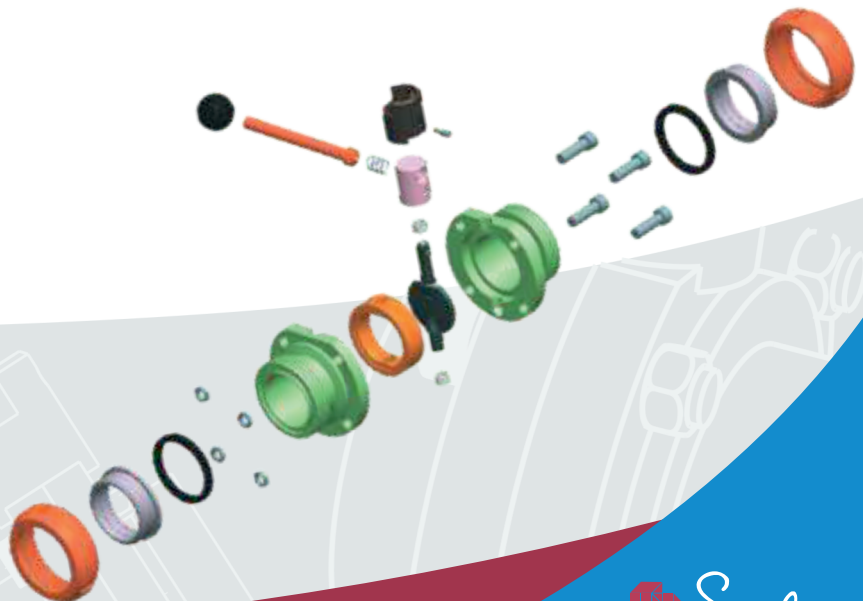

Product

Sanitary Manual Butterfly Valve



APPLICATION

- Stainless Steel Hygienic Butterfly Valves, which are very suitable applications for Dairy, Beverages, Chemicals, Pharma & Food Process Industries.

STANDARD DESIGN & FEATURES

- The valve consists of two valve bodies. The valve assembled by means of nut & bolts. The valve consists of flap disc, bushes & seal ring.
- The valve's disc is highly polished and crevice free which is easily cleaned.
- Ptfe stem bushing ensures the extra smooth disc rotations.
- Minimum flow resistance/pressure drop.
- SVP butterfly valves offers great durability and easy of use for wide range of service.
- Easy to install & maintain, butterfly valve close under pressure to form a leak tight seal .

BUTTERFLY VALVE TORQUE FIGURES NM

SIZE	25 mm	38 mm	51 mm	63 mm	76 mm	101 mm
MAX TORQUE	6	6	13.5	13.5	20.3	23

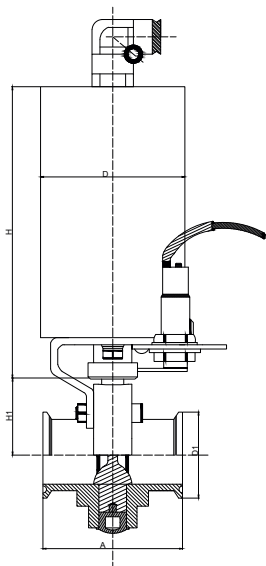

SIZE(MM)	D	A	H	H1	D1
25.4	86.3	66	172.5	42	50.5
38.1	86.3	70	172.5	46	50.5
50.8	86.3	76	172.5	54	64
63.5	86.3	80	172.5	60.5	77.5
76.2	86.3	84	172.5	67	91
101.6	86.3	104	172.5	80	119
152.4	133	146	295	137.5	167

TECHNICAL INFORMATION

- Working Pressure: - 0.9 to 10 Bar.
- Maximum Product Pressure: - 10 Bar
- Minimum Product Pressure: - full vaccum
- Maximum Temp. : + 95° C,
- Minimum Temp. : -10° C.

SPECIFICATIONS

- Gasket :- Nitrile / EMPDM / SILICON
- Finish :- SEMI BRIGHT,
- Product Wetted Steel Part :- AISI 304/316 & 316L
- Other Steel Part :- AISI 304

CONNECTIONS

Please mention :- SMS/IDF/DIN

SIZES

25 MM / 38 MM/ 51 MM / 63 MM / 76 MM



Product

Sanitary Pneumatic valves

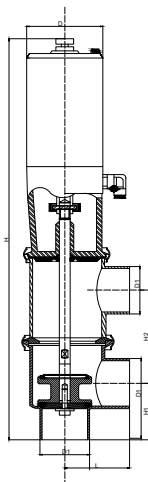

APPLICATION-

- SVP Valve shut of & changes over valve provide both a flexible & reliable solution. These valves are pneumatically operated & widely used in Food, Beverages, Dairy, Pharmaceutical & Chemical Industries.

STANDARD DESIGN & FEATURES-

- The valve consists of actuator and guider body, lip-seal, 2/3 way body with valve piston. All parts are assembled by means of clamp and stem clip-system
- SVP shut off & change over valve has excellent hygienic characteristics due to the valve Ball shaped housing body.
- The profile seat seal crevice free sealing & the compression of the seat seal controlled by a metallic stop. This prevents excessive wear & tear of rubber seal.
- The shaft seal is very wear resistant and is made from combination of Teflon & EPDM.

TECHNICAL INFORMATIONS:-

- Maximum Product Pressure: – 10 Bar
- Minimum Product Pressure: – full vacuum
- Maximum Temp. : + 150° C,
- Minimum Temp. : -10° C

SPECIFICATIONS -

- Product wetted:- AISI 304 / 304 L / 316 / 316 L
- Other steel parts:- AISI 304
- Rubber Part:- Epdm, Nbr, Silicon & Optional
- Plastic:- Ptpf & Optional
- Finish :- Semi Bright.

AIR SUPPLY PRESSURE: -

- Minimum : - 6 Bar
- Maximum : - 8 Bar

CONNECTIONS -

Please mention :- plain ends/union type/tri-clover

SIZES -

25 MM / 38 MM / 51 MM / 63 MM / 76 MM

D	A	B	C	E
38.1	25	287	79	50
50.8	25	293	94	62
63.5	25	305	113	82
76.2	32	368	129	87
101.6	32	380	163	134

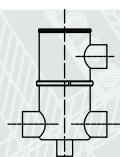

Fig. (3)

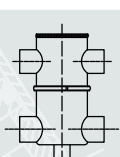

Fig. (4)

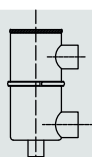

Fig. (1)

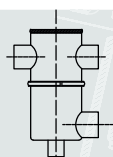

Fig. (2)



Product

Mixing Proof Valve



TECHNICAL SPECIFICATIONS:-

• WORKING PRINCIPLE :-

THE VALVE HAS TWO INDEPENDENT PLUG SEALS , FORMING A LEAKAGE CHAMBER BETWEEN THEM UNDER ATMOSPHERIC PRESSURE DURING EVERY WORKING CONDITION. IN CASE OF RARE ACCIDENTAL LEAKING OF PRODUCT , THIS WILL FLOW INTO THE LEAKAGE CHAMBER AND BE DISCHARGED THROUGH THE LEAKAGE OUTLET. WHEN THE VALVE IS OPEN , THE LEAKAGE CHAMBER IS CLOSED . TH PRODUCT CAN THEN FLOW FROM ONE LINE TO THE OTHER.

• STANDARD DESIGN :-

- MIXPROOF VALVE IS AN ONE PIECE BODY BUTTWELD 4 PORTS.
- FULLY MACHINED FROM 316/304 FORGING , OFFERING LOW PRIORITY AND GOOD CORROSION RESISTANCE.
- SELF DRAINING , CREVICE FREE INTERIOR IS EASY TO CLEAN .
- FULL FLOW , SPHERICAL DESIGN GIVES LOW PRESSURE DROP AND IS GENTLE ON YOUR PRODUCT.
- THINK TOP CONSISTS OF 2-PROXY SWITCHES , 3-SOLENOID VALVES , AND 8- PIN TRACK CONNECTOR .

• MATERIAL :-

1. PRODUCT WETTED STEEL PARTS :- ACID RESISTANT STEEL 316/304.
2. OTHER STEEL PARTS :- AISI SS 304.
3. PRODUCT WETTED SEALS :- EPDM RUBBER / NBR / SILICON &OPTIONAL
4. FINISH :- SEMI-BRIGHT .
5. PLASTIC :- PTPF AND OPTIONAL.
6. ACTUATOR SPRING :- SPRING STEEL.

• TECHNICAL DATA:-

1. MAX PRESSURE :- 60-70 Kpa (6-7 Bar).
2. MIN PRESSURE :- FULL VACUUM .
3. TEMP RANGE :- -10 DEGREE TO 140 DEGREE CELCIUS.
4. AIR PRESSURE :- 500-600 Kpa (5-6 Bar).

• CONNECTION :-

1. PLEASE MENTION :- PLAIN ENDS/ UNION TYPE / TRICLOVER

• SIZES :-

1. 25 MM / 38 MM / 51 MM / 63 MM / 76 MM

VALVE FROM AND NUMBER



"L" type



"T" type



"B" type



"C" type



"A" type



"E" type



"K" type



"V" type



"P" type



"O" type



"W" type



"Y" type



"X" type



"Z" type



"U" type



"M" type



"N" type



"G" type

OPERATING PRINCIPLES

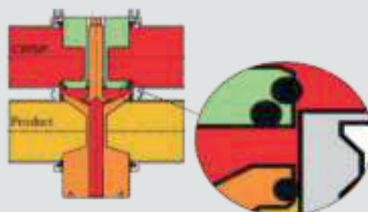

Pipe in Pipe Filter

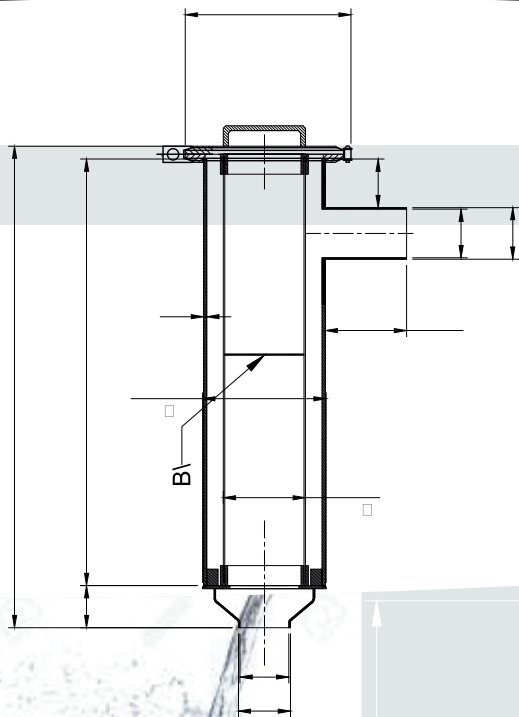

APPLICATION

Stainless Steel Hygienic Disc & Pipe in Pipe filters are widely used in Food Dairy, Beverages Pharmaceutical & Chemical Industries.

STANDARD DESIGN & FEATURES

- Sanitary disc type in line filter consists of two disc. The filter assembled by mean of tri-clover clamp, filter consists of perforated circle with 40 microns mesh & seal gasket
- Minimum flow resistance/pressure drop.
- Clamp Body Design ensure minimal down time, when sterilization / dismantle.
- SVP has constant focus on manufacturing of sanitary Filters with long durability, reliable & maximum possible strength.

TECHNICAL INFORMATION

- Maximum Pressure :- 10 Bar
- Maximum Temp. :- + 90° C,
- Minimum Temp. :- -20° C.

SPECIFICATIONS

- Product wetted :- AISI 304 / 304 L / 316 / 316 L
- Rubber Part :- EPDM, NBR, Silicon & Optional
- Finish :- Semi Bright, Buffed & Electropolish.

CONNECTIONS

Please mention :- SMS/IDF/DIN

SIZES

25 MM / 38 MM/ 51 MM / 63 MM / 76 MM/100 MM

D	A	B
25.4	130	195
38.1	130	195
50.8	130	195
63.5	148	306
76.2	148	306
101.6	148	306

Product

Sanitary Disc Type Inline Filter



APPLICATION

Stainless Steel Hygienic Disc & Pipe in Pipe filters are widely used in Food Dairy, Beverages Pharmaceutical & Chemical Industries.

STANDARD DESIGN & FEATURES

- Sanitary disc type in line filter consists of two disc. The filter assembled by mean of tri-clover clamp, filter consists of perforated circle with 40 microns mesh & seal gasket
- Minimum flow resistance/pressure drop.
- Clamp Body Design ensure minimal down time, when sterilization / dismantle.
- SVP has constant focus on manufacturing of sanitary Filters with long durability, reliable & maximum possible strength.

TECHNICAL INFORMATION

- Maximum Pressure :- 10 Bar
- Maximum Temp. :- + 90° C,
- Minimum Temp. :- -20° C.

SPECIFICATIONS

- Product wetted :- AISI 304 / 304 L / 316 / 316 L
- Rubber Part :- EPDM, NBR, Silicon & Optional
- Finish :- Semi Bright, Buffed & Electropolish.

CONNECTIONS

Please mention :- SMS/IDF/DIN

SIZES

25 MM / 38 MM/ 51 MM / 63 MM / 76 MM/100 MM

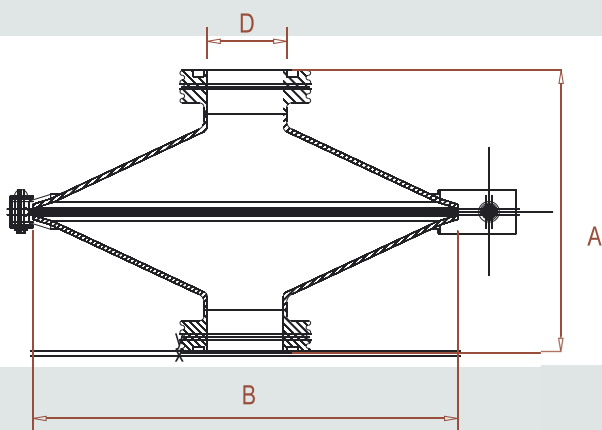

D	A	B
25.4	130	195
38.1	130	195
50.8	130	195
63.5	148	306
76.2	148	306
101.6	148	306

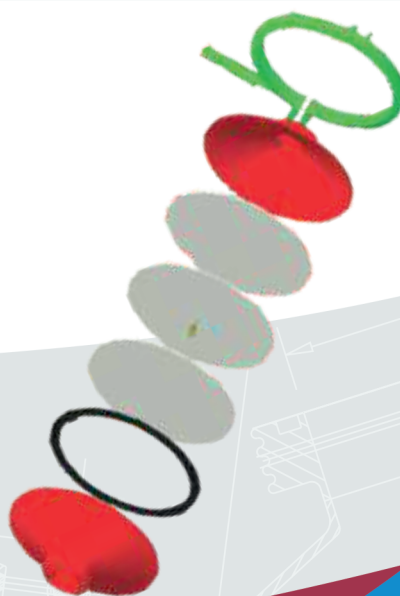

Product

Sanitary Fittings

APPLICATION

- Stainless Steel Hygienic Bend's, Tee's & Fittings are widely used in Food Dairy, Beverages & Personal Care Industries.



STANDARD DESIGN & FEATURES

- Sanitary Bend's, Tee's & Fittings are manufactured from seamless tube to ensure the product hygienic, safe, and free from the bacteria.
- SVP ensures that all Bend's, Tee's & Fittings all are at exact angles uniform wall thickness & exact diameter to ensure the good quality of the welding.
- SVP constantly focus on manufacturing of sanitary Bend's, Tee's & Fittings with long durability problem free welding & maximum possible strength.

TECHNICAL INFORMATION

- Maximum Pressure :- 10 Bar
- Maximum Temp. :- + 90° C,
- Minimum Temp. :- -20° C.

SPECIFICATIONS

- Product wetted :- AISI 304 / 304 L / 316 / 316 L
- Rubber Part :- EPDM, NBR, Silicon & Optional
- Finish :- Semi Bright, Buffed & Electropolish.

CONNECTIONS

Please mention :- SMS/IDF/DIN

SIZES - 25 MM / 38 MM/ 51 MM / 63 MM / 76 MM/100 MM

SHORT BEND

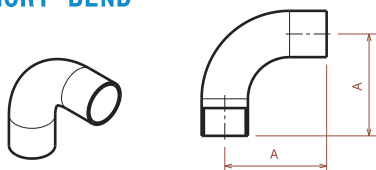

D	A
25.4	55
38.1	70
50.8	82
63.5	105
76.2	110
101.6	162

LONG BEND

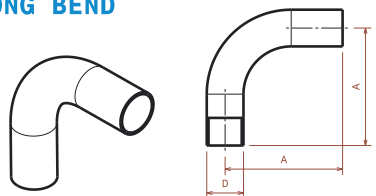

D	A
25.4	80
38.1	105
50.8	130
63.5	160
76.2	190
101.6	212

SHORT BEND-NUT, LINER & MALE PART

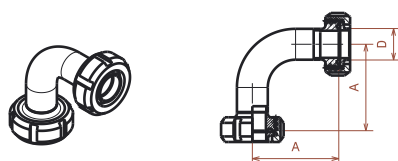

D	A
25.4	55
38.1	70
50.8	82
63.5	105
76.2	110
101.6	162

LONG BEND-NUT, LINER & MALE PART

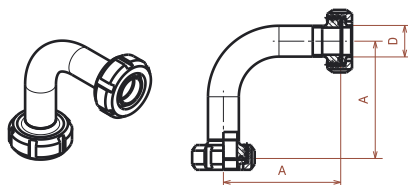

D	A
25.4	80
38.1	105
50.8	130
63.5	160
76.2	190
101.6	212

CONCENTRIC REDUCER

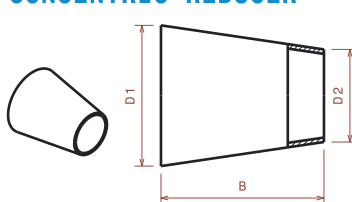

D1	D2	B
38.1	25	44
50.8	25	86
50.8	38	42
63.5	38	82
63.5	51	40
76.2	51	78
76.2	63.5	39
101.6	76	81

ECCENTRIC REDUCER

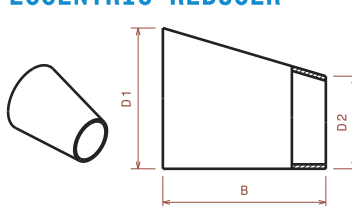

D1	D2	B
38.1	25	44
50.8	25	86
50.8	38	42
63.5	38	82
63.5	51	40
76.2	51	78
76.2	63.5	39
101.6	76	81

TEE

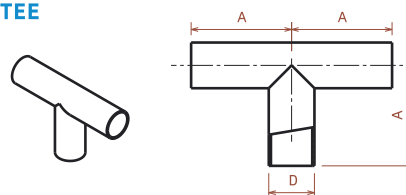

D	A
25.4	55
38.1	70
50.8	82
63.5	105
76.2	110
101.6	150

TEE- ALL ENDS NUT, LINER & MALE PART

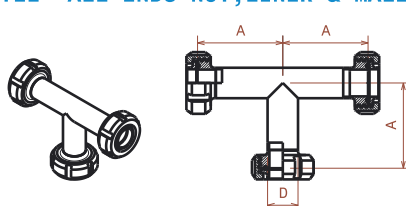

D	A
25.4	55
38.1	70
50.8	82
63.5	105
76.2	110
101.6	150

Product

Sanitary Unions



AVAILABLE SIZES - 25 mm / 38 mm / 51 mm / 63.5 mm / 76 mm / 101mm .

APPLICATION

- Stainless steel sanitary unions are widely used in process piping systems.
- Unions are used in food, dairy & chemical industries.

STANDARD DESIGN & BENEFITS

- The AISI Union is made to DIN/SMS/DF standard. The union consists of nut, liner, male part & gasket. Nut has a slots for spanner.
- SVP Unions are machined from forging & offering a good corrosion resistance, high quality and no porosity.
- Robust constructions enabling the repeated dismantling for sterilization & washing with no reduction in performance.



TECHNICAL INFORMATION

- Connections :-** Expanding Ends & Weldable Ends
- Gasket :-** Nitrile / EPDM / SILICON
- Thread :-** Round Type.
- Material :-** AISI 304 / 316 & 316L

WELDING UNION

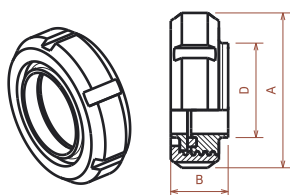

D	B	THREAD C
25.4	15	Rd 40-6
38.1	20	Rd 60-6
50.8	20	Rd 70-6
63.5	24	Rd 85-6
76.2	24	Rd 98-6
101.6	35	Rd 132-6

NUT

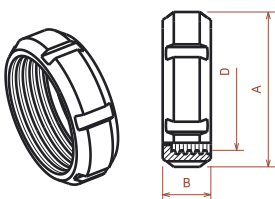

D	A	B	THREAD C
25.4	51	20	Rd 40-6
38.1	74	25	Rd 60-6
50.8	84	26	Rd 70-6
63.5	100	30	Rd 85-6
76.2	114	32	Rd 98-6
101.6	154	45	Rd 132-6

MALE NUT

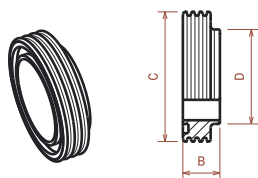

D	B	THREAD C
25.4	15	Rd 40-6
38.1	20	Rd 60-6
50.8	20	Rd 70-6
63.5	24	Rd 85-6
76.2	24	Rd 98-6
101.6	35	Rd 132-6

LINER

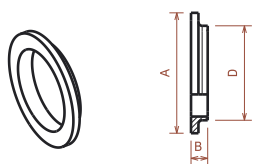

D	A	B
25.4	35.5	7.5
38.1	55	9
50.8	65	9
63.5	80	9
76.2	93	10
101.6	127	12

EXPANDING UNION

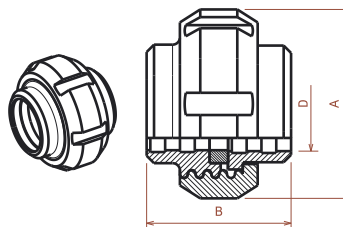

D	A	B
25.4	51	38
38.1	74	44
50.8	84	46
63.5	100	56
76.2	114	66

MALE NUT

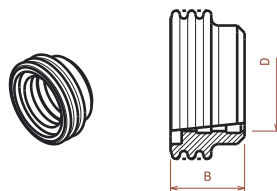

D	B
25.4	20
38.1	23
50.8	25
63.5	30
76.2	35

LINER

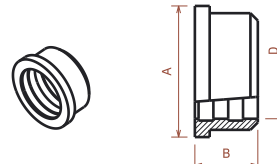

D	A	B
25.4	35.6	17
38.1	55	20
50.8	65	20
63.5	80	25
76.2	93	30

Product

Sanitary Non-Return valve



APPLICATION

SVP Non Return Valves are specially used in places where a backflow of product of pipeline must be avoided. These valves are mainly used in applications such as Dairies, beverages, chemical & pharmaceutical industries. The Valve is constructed to the highest specification, thus ensuring optimum level of hygiene and cleanliness by nature of its design.

STANDARD DESIGN & FEATURES

- The Non Return Valve body is in two parts, the valve assembled by means of Tri Clover Clamp & has a spring loaded plug with four legs. The valve is fitted with EPDM seal.
- Fully CNC Machined components in AISI 304/316L Stainless steel excellent corrosion resistance no porosity.
- Minimum flow resistance/pressure drop.
- Clamp Body Design ensure minimal down time, when sterilization / dismantle.
- Can be used in horizontal & vertical positions.
- Designed for CIP cleaning

NON-RETURN VALVE

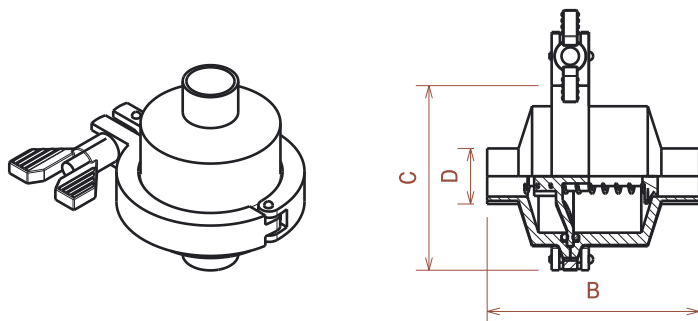

D	B	C
25.4	75	64
38.1	90	77
50.8	100	91
63.5	110	106
76.2	135	122
101.6	150	163

TECHNICAL INFORMATION

- Working Pressure :- 0.9 to 10 Bar.
- Maximum Temp. :- + 140° C.
- Minimum Temp. :- -10° C.

SPECIFICATIONS

- Product wetted :- AISI 304 / 304 L / 316 / 316 L
- Rubber Part :- EPDM, NBR, Silicon & Optional
- Finish :- SEMI BRIGHT,
- SPRING :- AISI 316 / 304

CONNECTIONS

Please mention :- SMS/IDF/DIN

SIZES

25 MM / 38 MM / 51 MM / 63 MM / 76 MM

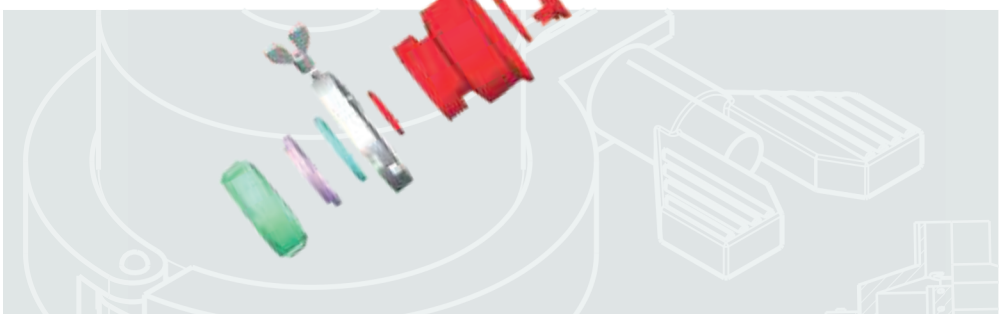

Product

Steam Water Mixing Battery



REGULAR TYPE



CONTROLLING TYPE

STEAM WATER MIXING BATTERY

SPRAY GUN

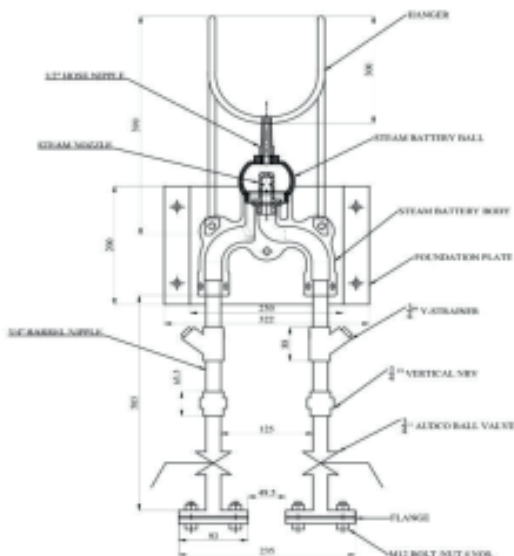

- Steam and water mixing battery, is used for washing the floor tiles, cleaning of vessels, equipments as well as for filling the same by hot water.
- It generates hot water instantly by blending steam with water as desired and required.
- It is available in two types 1. regular type (ball type) 2. Controlling type (to control the steam)
- It is available in S.S. 304 Casted body (Mixing Chamber)
- Accessories for regular type steam batter :- Non return valves, valves (Water & Steam) Y- Strainer, bracket (for wall mounting), Hanger (for hose pipe) Hose clamps & rubber hose pipe are included in the complete set of steam and water mixing battery .
- Accessories for controlling type steam batter :- Non return valves, valves (water & steam) Y-strainer, temp controller cum indicator (Radix make), Steam solenoid valve (Rotex make / spirax make), Bracket (for wall mounting), hanger (for hose pipe), hose clamps & rubber hose pipe are included in the complete set of steam and water mixing battery.
- Complete system can be made of either S.S. 304 construction as desired or in standard option.

CENTRIFUGAL PUMP



CENTRIFUGAL PUMP



SHEAR PUMP



LOBE PUMP



SELF PRIMING PUMP



MOBILE PUMP



DRAIN TRAP



POWDER BLENDER



STEAM BATTERY



WIRED MESH CABLE TRAY

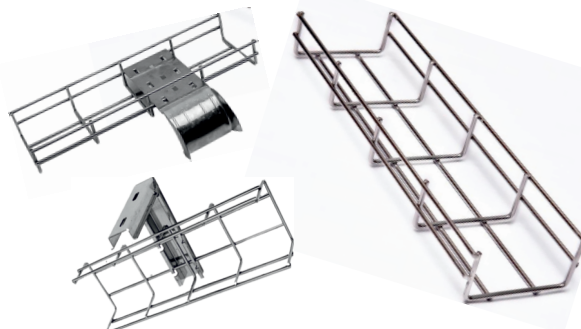

MANHOLE



DIAPHRAGM VALVE



MIXING PROOF VALVE



FLOW DIVERSION VALVE



BUTTERFLY VALVE

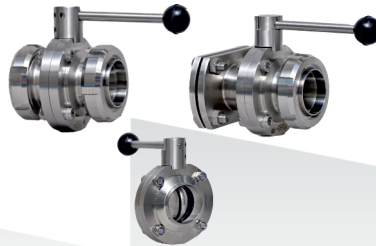

BFV WITH ACTUATOR



PIPE IN PIPE FILTER



PLUG VALVE



NON-RETURN VALVE



UNIONS



DISC TYPE FILTER



SS FITTING



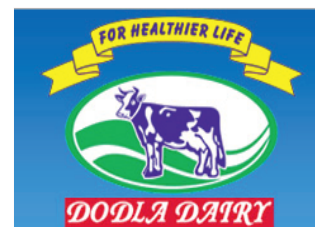

CONVERSION TABLE OF SURFACE FINISHES

Mechanical finish			Electro polished
150 Grit	32 Ra	0.9µm	
180 Grit	20 Ra	0.5 µm	0.5 µm
240 Grit	14 Ra	0.38 µm	0.38 µm
280 Grit	10 Ra	0.25 µm	0.25 µm



STAINLESS STEEL INFORMATION

Grades		Composition Element					
		Cr.	Ni	Mo	N	Mn	C
AISI 304	This is the worlds most popular stainless steel. Used throughout the hygienic fluid handling industries for quality equipment not in contact with the product.	18 - 20	8 - 12	–	0.1	2.0	0.08
AISI 304 L	This is a low carbon version which improves resistance to intergranular corrosion caused by welding.	18 - 20	8 - 12	–	0.1	2.0	0.03
AISI 316	In damp atmospheres 316 grades perform better than 304 grades, 316 grades are used throughout the hygienic fluids handling industries for components in contact with product.	16 - 18	10 - 14	2 - 3	0.1	2.0	0.08
AISI 316 L	This is a low carbon version which improves resistance to intergranular corrosion caused by welding.	16 - 18	10 - 14	2 - 3	0.1	2.0	0.03

Cr. – Chromium, Ni. – Nickel, Mo – Molybdenum, N. – Nitrogen, Mo- Manganese, C - Carbon

MATERIALS

Polymers	Chemical Resistance	Continuous Service Temperature Max. Application temperature in dry atmospheric air.
PTFE	PTFE is suitable for almost all media except for attach by alkaline metals, fluorine and some halogenated compounds at high temperatures.	-10°C to +230 °C
NITRILE	Very good resistance to all foods, to certain solvents to dilute basis and acids to inorganic salt solutions and to ozone.	-30°C to +90 °C
EPDM	Good resistance to heat, saturated steam abrasion and ageing, EPDM has excellent resistance to hydraulic fluids, diluted acids and bases. Unsuitable for use with mineral oils.	-50°C to +140 °C
SILICON	Very good resistance to high and low temperature. Normal resistance to ageing extreme weather conditions and ozone, bases and acids at average temperature and concentrations. Unsuitable for use with aggressive oils,. Not recommended for use with hot water or steam. Weak mechanical properties.	-50°C to +200 °C
VITON	Excellent chemical resistance. Good resistance to high temperature air and oil micro organisms, certain solvents and ozone. Good mechanical properties. Not recommended for use with hot water or steam.	-20°C to +200 °C

Temperature range depends on product range, please consult.

ELASTER & THERMOPLASTICE CHARACTERSTICS

Material code	BUNA 'U' K830	EPDM 'E' K832	VITON SFY K834 Steam Resistant	Silicon x k835	PIPE 'G' K829	Envelop 'GR' K831
Temperature	-50°C to 100 °C	-50°C to 150 °C	-30°C to 180 °C	-60°C to 230 °C	-40°C to 230 °C	-40°C to 230 °C
Acid	Good	Good to ex.	Good Ex.	Poor to Good	Good to Ex.	Good to Ex.
Alkali	Fair to Good	Good to ex.	Poor to Good	Poor to Fair	Excellent	Excellent
Fats/Oils	Good to Ex	Poor	Good to Ex.	Poor to Good	Excellent	Excellent
Taste	Good	Good	Good	Good	Excellent	Excellent
Steam Resist	Fair	Excellent	Good to Ex.	Excellent	Fair	Excellent
Odour	Good	Good	Good	Good	Excellent	Excellent
Abrasion resist	Excellent	Good	Good	Poor	Fair	Fair
Compression set depends on type of oil	Good	Fair	Good to ex.	Good to Ex.	Cold Flows	Cold Flows
Colour Code	Red	Green	Yellow & White	Pink	None	None



AN ISO 9001:2008 CERTIFIED COMPANY

Dhayari - Narhe Road, Pune - 411 041. S. No. 28/27, Near Pari Company,
Ph. : + 91 - 020 - 65001482 / 24690268. (M) + 91 9028716622, + 91 99231 24949
Email : swastikpune@gmail.com sales1swastik@gmail.com